



(064) 6642488



0879256676



info@molengineers.ie



www.molengineers.ie



Mr. Damien Ginty,  
Senior Planner,  
Planning Policy Unit,  
Kerry County Council,  
Rathass, Tralee,  
Co. Kerry,  
V92H7VT

3<sup>rd</sup> October 2023

Dear Damien,

**Re: Submission on the Draft Kenmare Municipal District Local Area Plan 2023-2029**

Our client Mr. Tim O'Reilly is the owner of lands in Kilgarvan village which have an area of 1.5 hectares or 3.7 acres.

On behalf of our client, we request that the lands outlined in red on the Ordnances Survey Ireland map to a scale of 1:2,500 be zoned "proposed residential" and be included within the Kilgarvan village boundary. We have enclosed the map in Appendix A of this submission.

The grounds and justifications for the change to the zoning to "proposed residential" are summarised as follows:

1. The lands are on the Western side of the village and have direct access to the R569. Compliant sight distances are available at the proposed site entrance.
2. The lands adjoin the local GAA Hurling and Football club.
3. The lands are within walking distance of all amenities including the church, shops, school, garda station.
4. The lands are close to the existing public sewerage system.
5. The lands are serviced by a public water supply.

We hope the above is acceptable to you and should you have any queries please do not hesitate to contact the undersigned.

Yours sincerely,

Denis O'Leary B.Sc. Con. Tech. MCIOB  
For MOL Consulting Engineers Ltd.

# APPENDIX A

## Ordnance Survey Map

# Planning Pack Map

**CENTRE COORDINATES:**  
ITM 500073.573448

**PUBLISHED:** 31/01/2022 **ORDER NO.:** 50247012\_1

**MAP SERIES:** 1:5,000 6320  
1:2,500 6321-C

**COMPILED AND PUBLISHED BY:**  
Ordnance Survey Ireland,  
Phoenix Park,  
Dublin 8,  
Ireland.

Unauthorised reproduction  
infringes Ordnance Survey Ireland  
and Government of Ireland  
copyright.

All rights reserved.  
No part of this publication may  
be copied, reproduced  
or transmitted in any form  
or by any means without the prior  
written permission of  
the copyright owners.

The representation on this map  
of a road, track or footpath  
is not evidence of the existence  
of a right of way.

Ordnance Survey maps  
never show legal property  
boundaries, nor do they  
show ownership of  
physical features.

© Suirbheireacht Ordánais Éireann,  
2022  
© Ordnance Survey Ireland, 2022  
[www.osi.ie/copyright](http://www.osi.ie/copyright)

**LEGEND:**  
<http://www.osi.ie/>  
search 'Large Scale Legend'

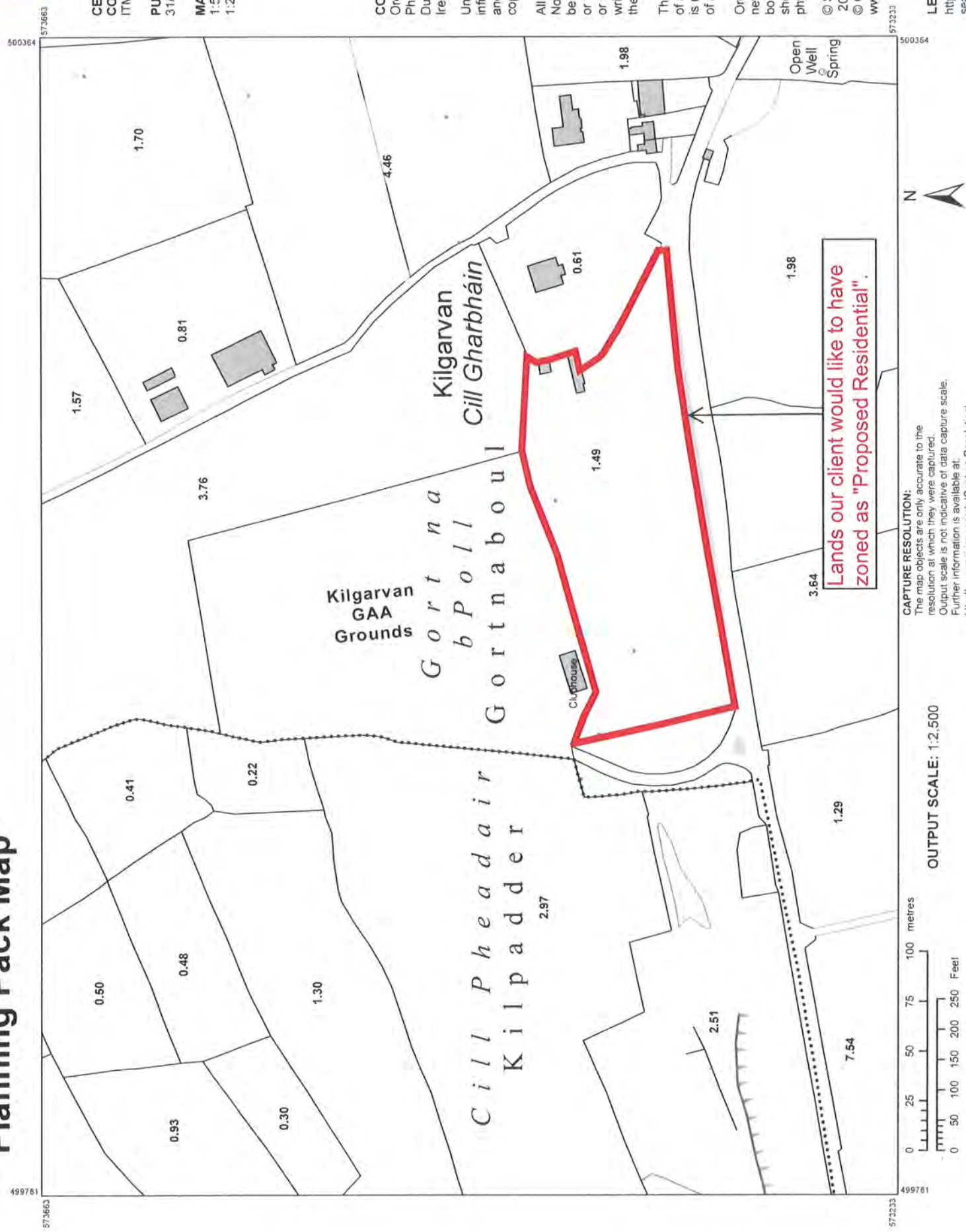

500364

499781

573663

573233