



## A Chara

The Peninsula Park was officially opened by the President of Ireland in 2022, as one of the only two public parks in Kenmare which are owned by Kerry County Council. It is important that the public have easy and safe access to the Public Parks from the town of Kenmare and that emergency vehicles also have multiple access options.

Currently the 13.7 acres at the Peninsula Park is accessed via.

*"a right of way of only sixteen feet in width on foot and with or without animals or vehicles mechanical or otherwise along and over the passage from the public road at the pier head Kenmare".*

This is a very narrow access way for the park and for health and safety reasons an alternative access point should be secured by the Council to ensure in the event of the pier road being inaccessible to emergency vehicles that an alternative is available.

Currently the Council has a right of way that goes part of way to the Peninsula Park towards Market Street, marked yellow on the attached map. During the negotiation to purchase the Peninsula land the council was granted by one of the other parties involved.

*"a right of way over the part of its (the other parties) land coloured yellow on the composite map"*

This right of way appears to stop at the gate near the stone circle. This legal right of way, in favour of the Council is not currently usable as there appears to be debris on it. The Council should use the powers at its disposal to clear the debris off its right of way.

The Council should also include the current right of way towards Market Street in the Kenmare Town Development Plan, as previous plans had shown this access, with the aspiration, again using the powers at its disposal, to secure the remaining access needed towards the town so that the Peninsula Park can be safely enjoyed for generations to come.

Is Mise le Meas

  
Senator Mark Daly

**Seanad Éireann**  
Leinster House  
Kildare Street  
Dublin 2

**Seanad Éireann**  
Teach Laighean  
Sráid Chill Dara  
Baile Átha Cliath 2



# Land Registry Compliant Map

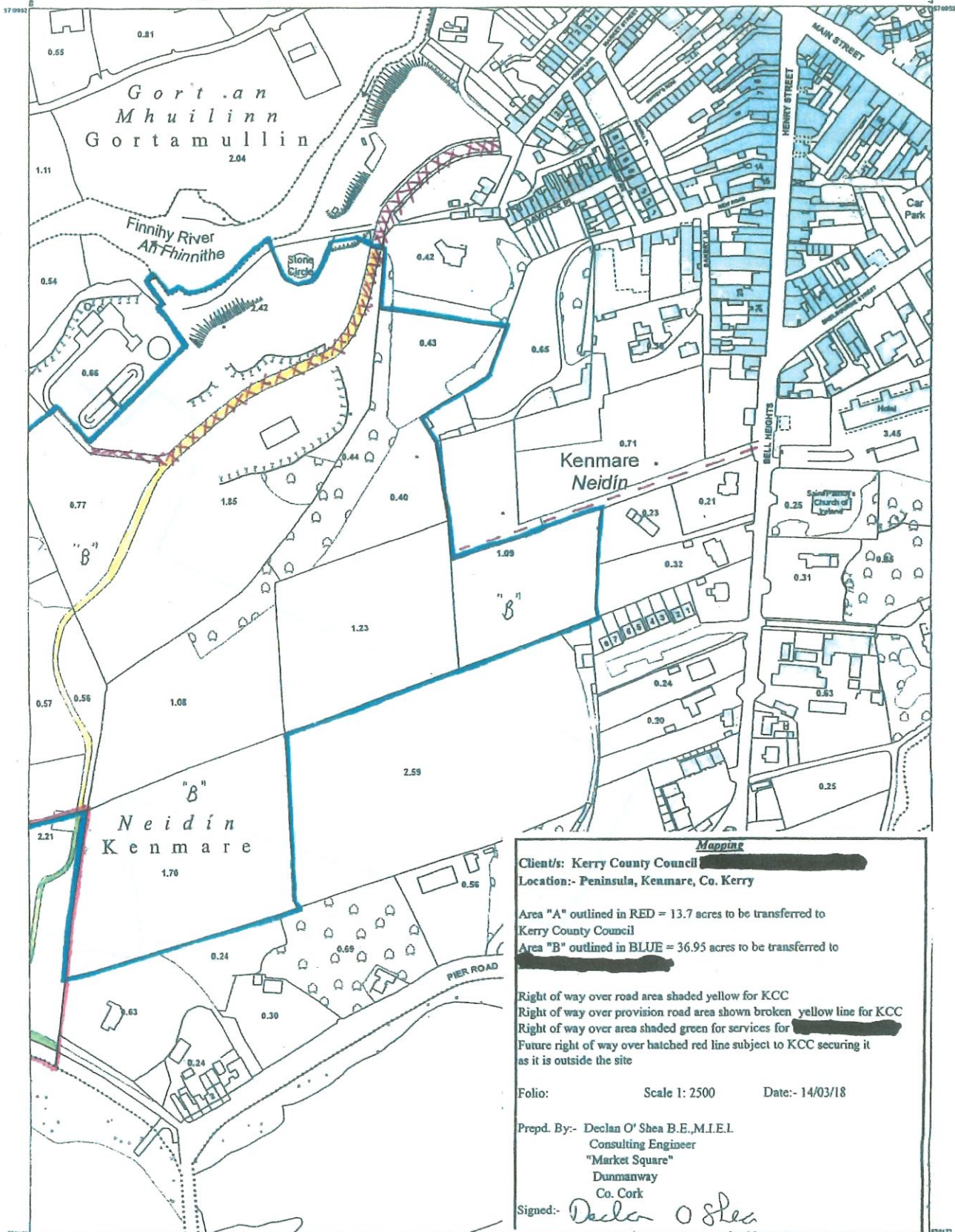

**Mapping**

Client/s: Kerry County Council  
 Location:- Peninsula, Kenmare, Co. Kerry

Area "A" outlined in RED = 13.7 acres to be transferred to Kerry County Council  
 Area "B" outlined in BLUE = 36.95 acres to be transferred to [REDACTED]

Right of way over road area shaded yellow for KCC  
 Right of way over provision road area shown broken yellow line for KCC  
 Right of way over area shaded green for services for [REDACTED]  
 Future right of way over hatched red line subject to KCC securing it as it is outside the site

Folio: Scale 1: 2500 Date:- 14/03/18

Prepd. By:- Declan O' Shea B.E., M.I.E.I.  
 Consulting Engineer  
 "Market Square"  
 Dunmanway  
 Co. Cork

Signed:- *Declan O'Shea*

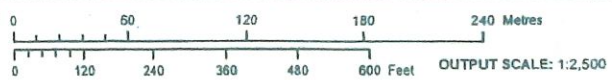

COMPILED AND PUBLISHED BY:  
 Ordnance Survey Ireland,  
 Phoenix Park,  
 Dublin 8,  
 Ireland.

All rights reserved.  
 No part of this publication may be copied, reproduced or transmitted in any form or by any means without the prior written permission of the copyright owners.

Ordnance Survey maps never show legal property boundaries, nor do they show ownership of physical features.

MAP SERIES  
 1:1,000  
 1:2,500



CENTRE COORDINATES:  
 ITM 490770,570537

ORDER NO.: 50006558\_1  
 PUBLISHED: 08/05/2018

©Suirbhéireacht Ordáná Eireann, 2018  
 ©Ordnance Survey Ireland, 2018  
 www.osi.ie/copyright

MAP SHEETS:  
 6363-24  
 6363-D

**CAPTURE RESOLUTION:**  
 The map objects are only accurate to the resolution at which they were captured. Output scale is not indicative of data capture scale. Further information is available at: <http://www.osi.ie>; search 'Capture Resolution'

**LEGEND:**  
<http://www.osi.ie>; search 'Large Scale Legend'

Unauthorised reproduction infringes Ordnance Survey Ireland and Government of Ireland copyright.

The representation on this map of a road, track or footpath is not evidence of the existence of a right of way.





# Land Registry Compliant Map

**Mapping**  
 Client/s: Kerry County Council & [REDACTED]  
 Location:- Peninsula, Kenmare, Co. Kerry

Area "A" outlined in RED = 13.7 acres to be transferred to Kerry County Council  
 Area "B" outlined in BLUE = 36.95 acres to be transferred to [REDACTED]

Right of way over road area shaded yellow for KCC  
 Right of way over provision road area shown broken yellow line for KCC  
 Right of way over area shaded green for services for [REDACTED]  
 Future right of way over hatched red line subject to KCC securing it as it is outside the site

Folio: Scale 1: 2500 Date:- 14/03/18

Prepd. By:- Declan O' Shea B.E., M.I.E.I.  
 Consulting Engineer  
 "Market Square"  
 Dunmanway  
 Co. Cork

Signed:- *Declan O' Shea*

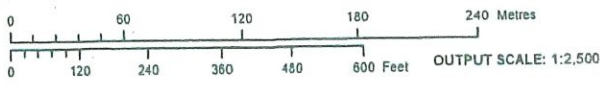
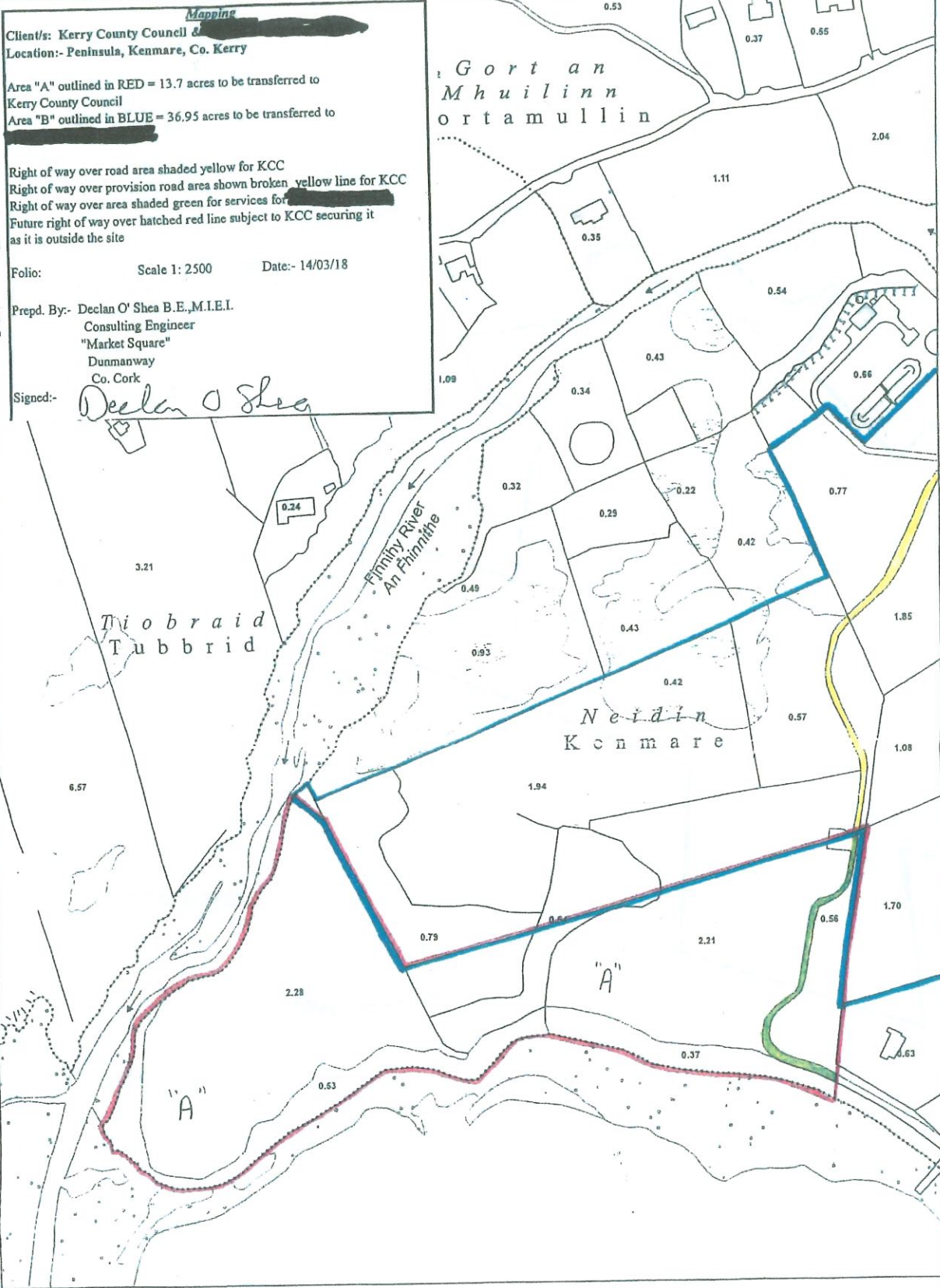

CENTRE COORDINATES:  
 ITM 490248,370537

ORDER NO.: 50006562\_1 PUBLISHED: 08/05/2018

©Suirbhéireacht Ordanáis Éireann, 2018  
 ©Ordnance Survey Ireland, 2018  
 www.osi.ie/copyright

**CAPTURE RESOLUTION:**  
 The map objects are only accurate to the resolution at which they were captured. Output scale is not indicative of data capture scale. Further information is available at: <http://www.osi.ie>; search 'Capture Resolution'

**LEGEND:**  
<http://www.osi.ie>; search 'Large Scale Legend'

COMPILED AND PUBLISHED BY:  
 Ordnance Survey Ireland,  
 Phoenix Park,  
 Dublin 8,  
 Ireland.

All rights reserved. No part of this publication may be copied, reproduced or transmitted in any form or by any means without the prior written permission of the copyright owners.

Ordnance Survey maps never show legal property boundaries, nor do they show ownership of physical features.

MAP SERIES:  
 1:2,500  
 1:2,500



MAP SHEETS:  
 6363-C  
 6363-D

Unauthorised reproduction infringes Ordnance Survey Ireland and Government of Ireland copyright.

The representation on this map of a road, track or footpath is not evidence of the existence of a right of way.

